

- This drawing is to be read in conjunction with all other relevant drawings and specifications. See Document 2.16D & E for Railway Longitudinal Sections. See Documents 2.16A to C for Railway Cross Sections.
- This drawing is based on the Ordnance Survey Data issued by Chetwoods licence no. 100031961. All design information is subject to confirmation by rail corridor topographic survey.
- Site datum (design datum) chainage of 0m is set at point of switch of proposed connection turnout on Down Penkridge main line at approximately 19m 1580yds and increasing with the track mileage.
- Proposed track works and specific alignments are subject to detailed design.

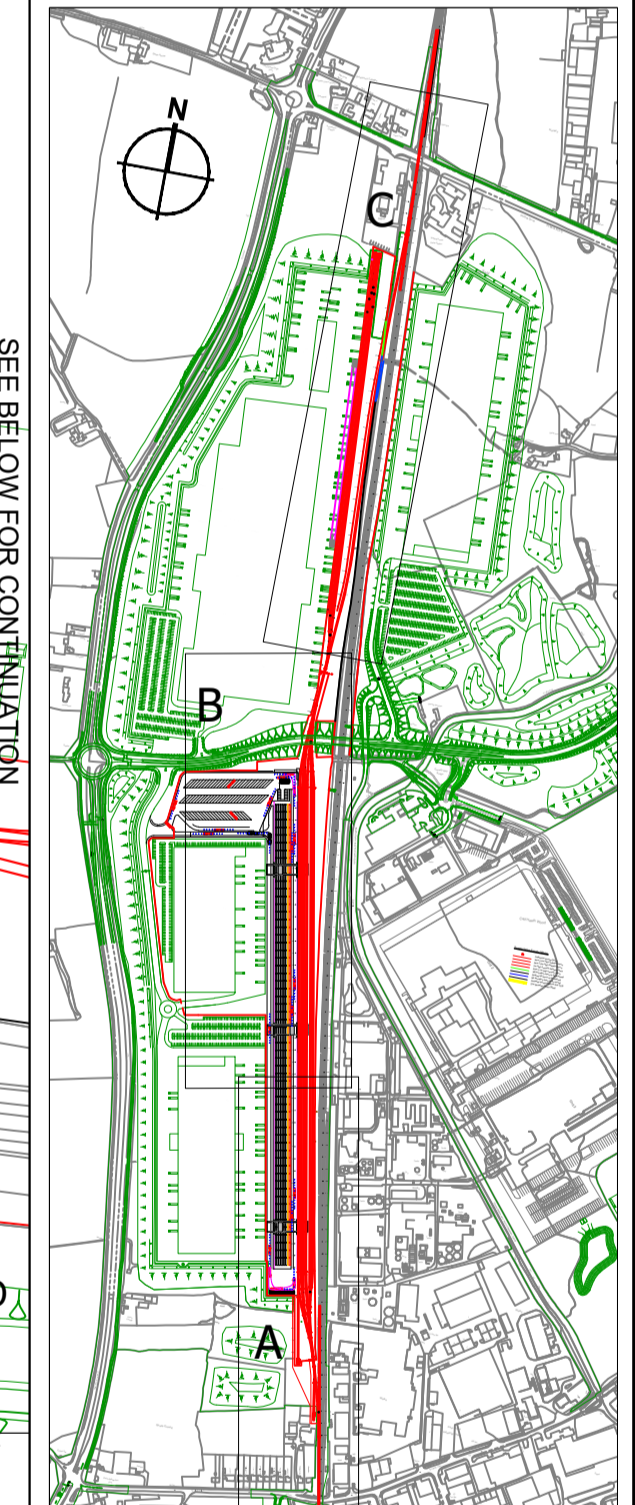

Revisions	
R05	APR 2023 UPDATED TO SHOW ACOUSTIC FENCE
P04	JAN 2023 UPDATED TO REFLECT E33 SUBMISSION
P03	MAR 2018 MINOR ORDER LIMITS AMENDMENTS
P02	FEB 2018 MAIN LINE CONNECTION AMENDMENTS
P01	NOV 2017 DCO SUBMISSION

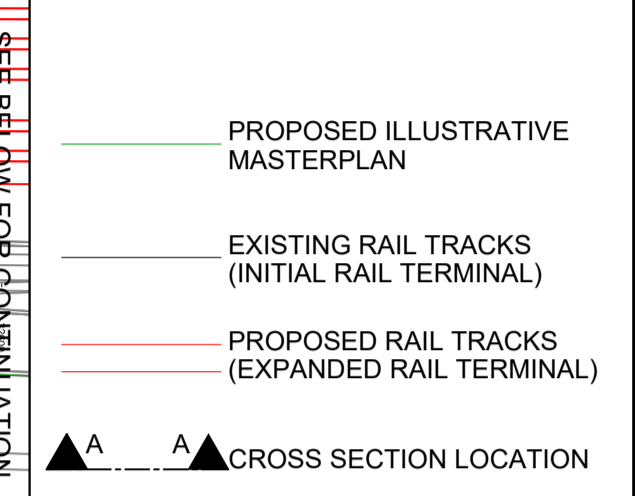

Project	
The West Midlands Rail Freight Interchange Order 2020	
Drawing Status	
SUBMISSION	
Drawing Title	
ILLUSTRATIVE ARRANGEMENT OF RAIL ALIGNMENT	
Drawing Size A1	
Regulation	Document
5 (2) (o)	2.14
Drawn AT	Date MAR 2018
Scale 1:1000 (A1)	Reviewed MT
Drawing No.	Rev.
TRS-DRG-FA-001003	05